

BACK VIEW II SCALE 1:5

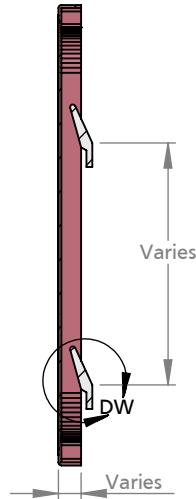

SECTION A-A II SCALE 1:5

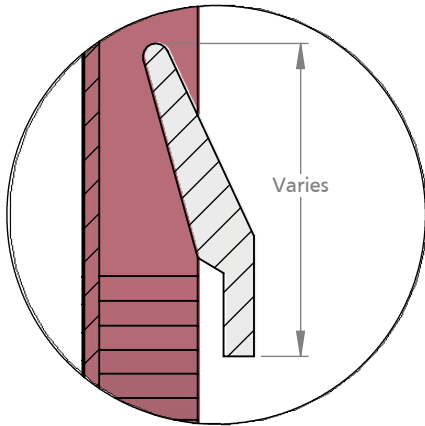

DETAIL DW II SCALE 1:1

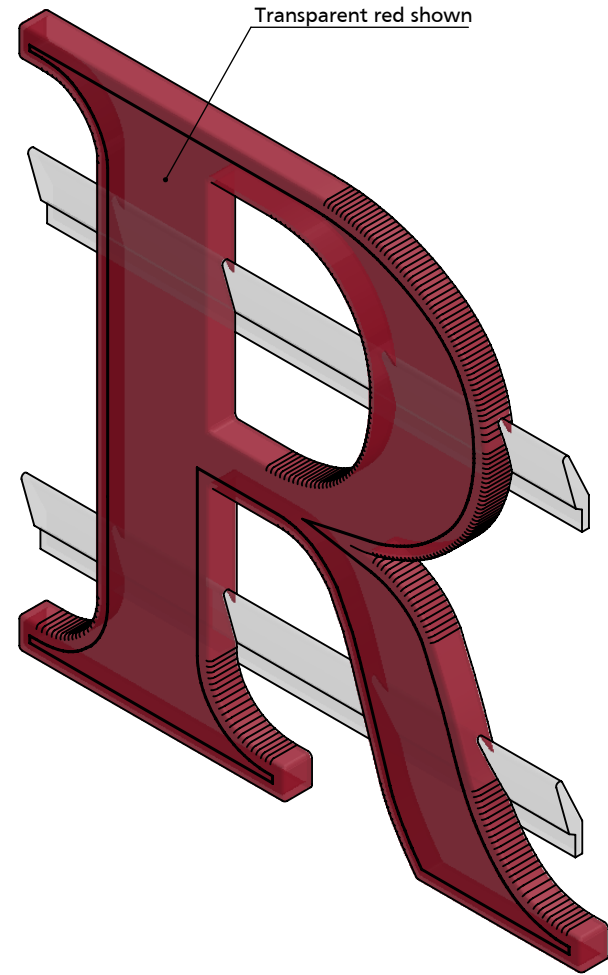

ISOMETRIC BACK VIEW II SCALE 1:3

- Notes:
- 6" Letters - Slots are 5" on center
 - 8" up to 10" letters - Slots are 7" on center
 - Letters are transparent red or black injection molded.
 - Install with clear acrylic slotted track (6", 8", 10" lengths).
 - Change letters with "Slotted Change Arm"
 - Letters and standard symbols available.



TITLE:

SLOTTED B MARQUEE LETTERS

MATERIAL:

C.A.B

PRODUCT TYPE:

PLASTIC CHANGEABLE LETTERS

DWG NO. SLOT10

REV 02/19/15

SCALE: AS INDICATED

SHEET 1 OF 1